

PARTS AND INSTRUCTION MANUAL

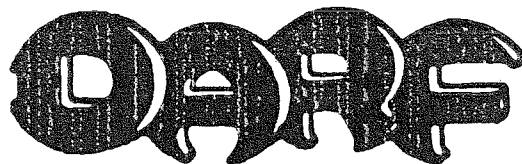

**MODELS 925 AND 930
15 WHEEL HYDRAULIC OPENING AND CLOSING HAY RAKE**

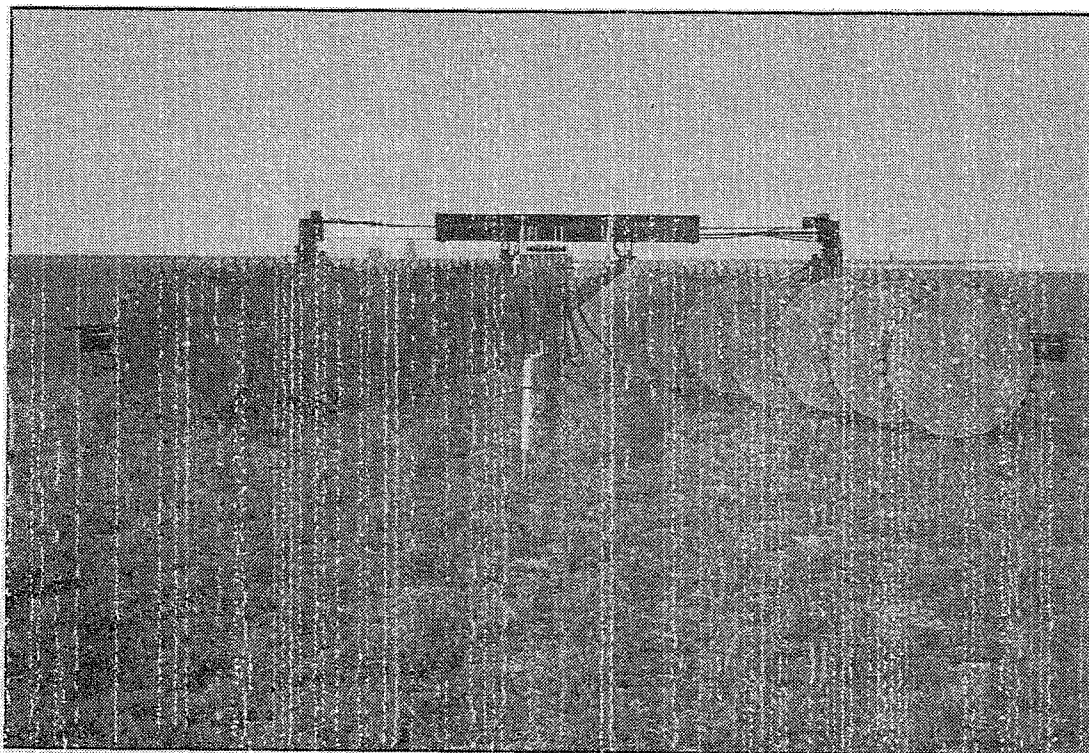

MODEL 930FD

Manufactured by
NIKKEL IRON WORKS, INC.
SHAFTER, CA 93263

Use Only Genuine **DARE** Parts

RAKING FRAMES AND LIFT TUBES

REF	PART NUMBER	DESCRIPTION	QTY
1	92293	RAKING FRAME - RIGHT	1
2	92292	RAKING FRAME - LEFT	1
3	92291	LIFT TUBE - RIGHT	1
4	92290	LIFT TUBE - LEFT	1
5	CSNC08X80	1/2 X 5 NC CAPSCREW - GR 5	AR
6	922990	CYLINDER BRACKET - RAKING FRAME - FD MODEL	2
7	922995	CLAMP PLATE	3
8	3008SAE	3 X 8 ASAE ANGLE CYLINDER	2
9	92RC19	1" CYLINDER PIN	2 PER CYL
10	HAIR12	HAIR PIN - #12	4 PER CYL
11	CSNC08X112	1/2 X 7 NC CAPSCREW - GR 5	AR
12	922991	CYLINDER BRACKET - LEG STRUT - FD MODEL	2
13	922992	CLAMP PLATE	4
14	LW08SP	1/2 LOCK WASHER	AR
15	NUT08NC	1/2 NC NUT - GR 5	AR
16	92115	BUSHING	60
17	B511ZERK	DRIVE IN ZERK	AR
18	9047	Not used with 9047 bushing	6
19	CSNC06X48	UMHW BUSHING - AFTER S/N 54591	AR
20	CSNC06X40	3/8 X 3 NC CAPSCREW - GR 5	AR
21	2053	3/8 X 2-1/2 CAPSCREW - GR 5	4
22	FLTWA06	PIPE BUSHING	AR
23	LW06SP	3/8 FLAT WASHER	AR
24	NUT06NC	3/8 LOCK WASHER	AR
25	92122A	3/8 NC NUT - GR 5	AR
26	92122	CHAIN ASSEMBLY - COMPRESSION SPRING	15
27	92193	CHAIN - EXTENSION SPRING	15
28	2008SAE	LIFT TUBE END	2
29	TL165P	2 X 8 ASAE LIFT CYLINDER	2
30	922993	ADJUSTING LINK	STD 4 - FD 2
31	922994	ADJUST LINK BRACKET - LEG STRUT - STD MODEL	2
32	P772	ADJUST LINK BRACKET - RAKING FRAME - STD MODEL	2
33	2016	3/4 ADJUSTING LINK PIN - STD MODEL	4
		LINCH PIN	AR

Quantities are per rake unless otherwise stated

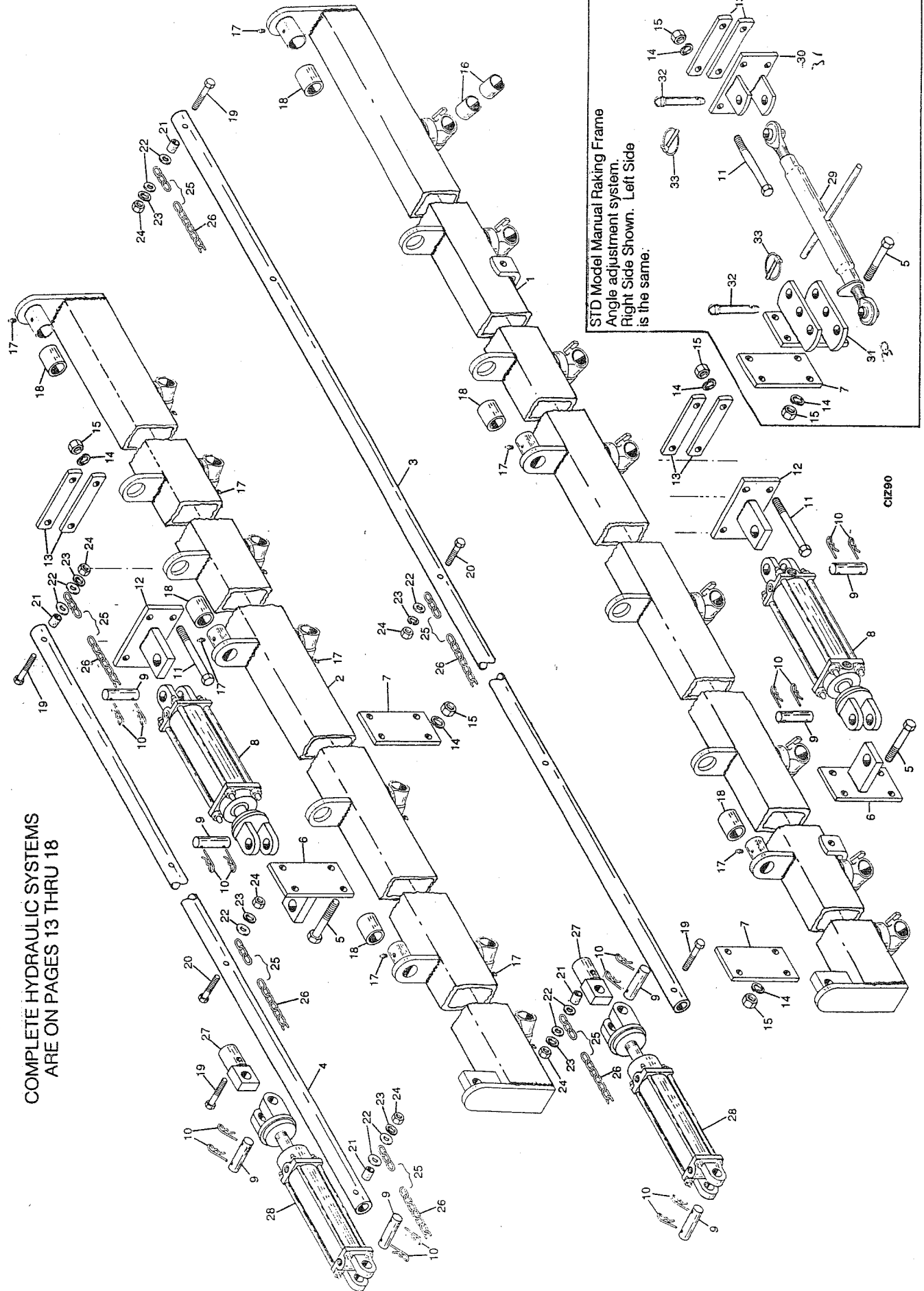

COMPLETE HYDRAULIC SYSTEMS
ARE ON PAGES 13 THRU 18

C1Z90

LEFT STRUT AND GROUND WHEEL

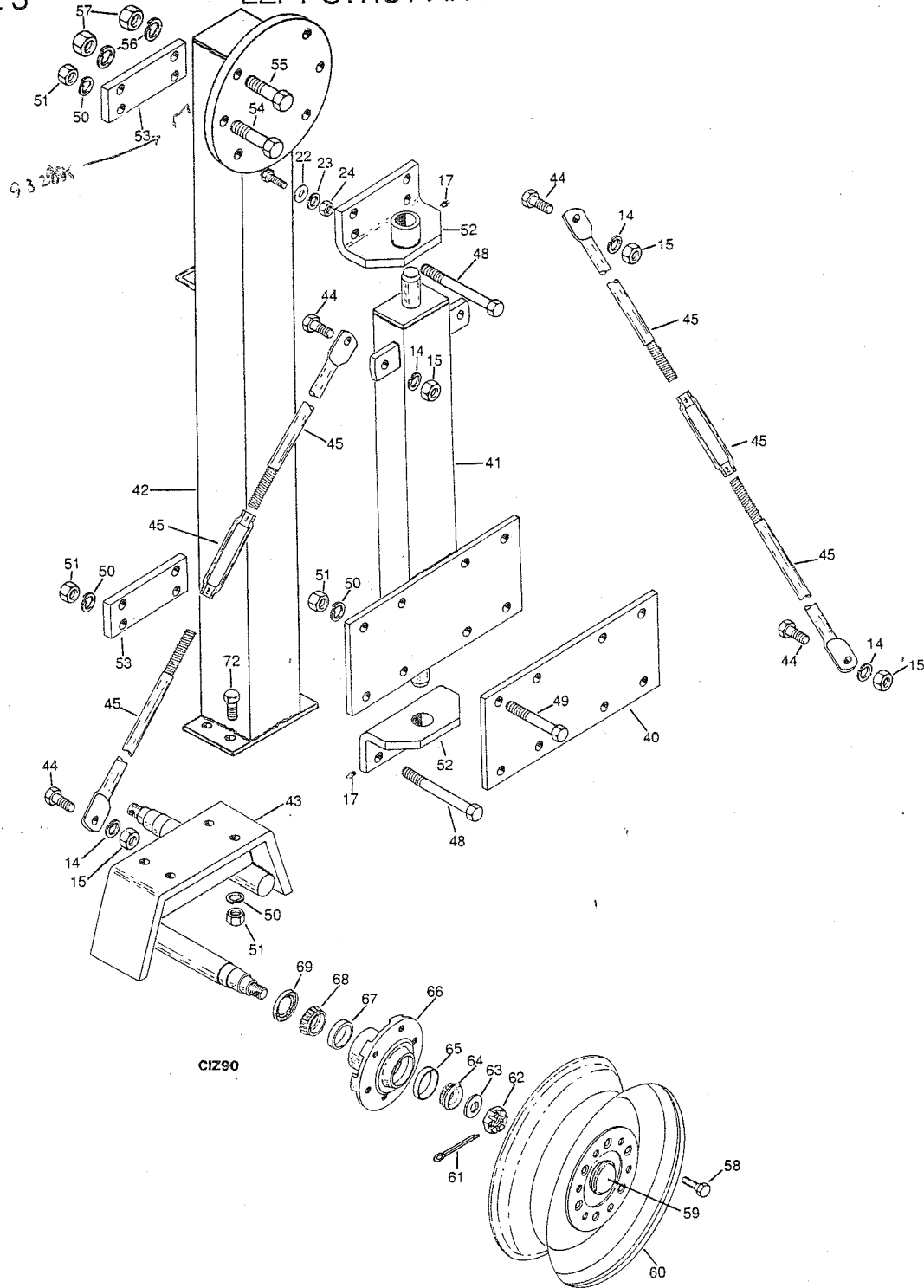

REF	PART NUMBER	DESCRIPTION	QTY	REF	PART NUMBER	DESCRIPTION	QTY
14	LW08SP	1/2 LOCK WASHER	AR	54	CSNC12X56	3/4 X 3-1/2 CAPSCR GR 8	AR
15	NUT08NC	1/2 NUT NC GR - 5	AR	55	CSNC12X48	3/4 X 3 CAPSCR - GR 8	AR
22	FLTWA06	3/8 FLAT WASHER	AR	56	LW12SP	3/4 LOCK WASHER	AR
23	LW06SP	3/8 LOCK WASHER	AR	57	NUT12NC	3/4 NUT NC - GR 5	AR
24	NUT06NC	3/8 NUT NC GR - 5	AR	58	9036	LUG BOLT	24
40	92210	CLAMP PLATE	2	59	9041	GREASE CAP	AR
41	92582	PIVOT, LEFT OR RIGHT	2	60	92148	GROUND WHEEL	4
42	92581	STRUT, LEFT OR RIGHT	2	61	COT32P	COTTER	AR
43	92590L	SPINDLE ASSY, LEFT	1	62	92125	7/8 SLOTTED NUT - GR 5	AR
44	CSNC08X24	1/2 X 1-1/2 CAPSCR - GR 5	AR	63	9043	FLAT WASHER	AR
45	92589	GUY ROD ASSY	4	64	9040	CONE, OUTER (67048)	4
48	CSNC10X112	5/8 X 7 CAPSCR - GR 5	AR	65	9042	CUP, OUTER (LM67010)	4
49	CSNC10X80	5/8 X 5 CAPSCR - GR 5	AR	66	9035	HUB ASSY, INCL CUPS	4
50	LW10SP	5/8 LOCK WASHER	AR	67	9037	CUP, INNER (JL69310)	4
51	NUT10NC	5/8 NUT NC - GR 5	AR	68	9039	CONE, INNER (JL69349)	4
52	92583	PIVOT BRACKET	4	69	9038	GREASE SEAL	1
53	92584	CLAMP PLATE	4	72	CSNC10X32	5/8 X 2 CAPSCR - GR 5	AR

Quantities are per rake

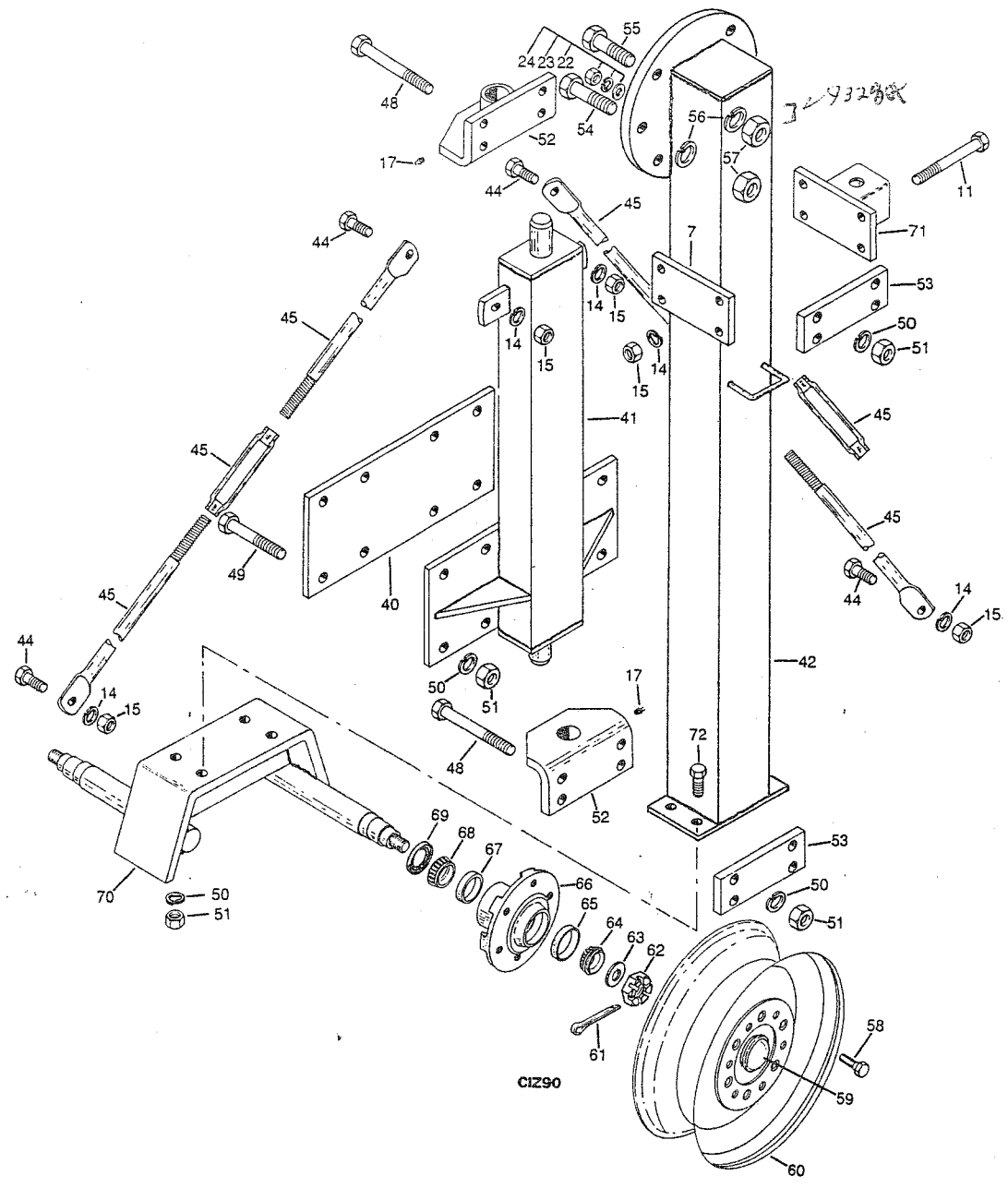

REF	PART NUMBER	DESCRIPTION	QTY	REF	PART NUMBER	DESCRIPTION	QTY
14	LW08SP	1/2 LOCK WASHER	AR	56	LW12SP	3/4 LOCK WASHER	AR
15	NUT08NC	1/2 NUT NC GR 5	AR	57	NUT12NC	3/4 NUT NC - GR 5	AR
17	B511ZERK	DRIVE-IN ZERK	AR	58	9036	LUG BOLT	24
22	FLTWA06	3/8 FLAT WASHER	AR	59	9041	GREASE CAP	AR
23	LW06SP	3/8 LOCK WASHER	AR	60	92148	GROUND WHEEL	4
40	92210	CLAMP PLATE	2	61	COT12P	COTTER	AR
41	92582	PIVOT, LEFT OR RIGHT	2	62	92125	7/8 SLOTTED NUT - GR 5	AR
42	92581	STRUT, LEFT OR RIGHT	2	63	9043	FLAT WASHER	AR
44	CSNC08X24	1/2 X 1-1/2 CAPSCR - GR 5	AR	64	9040	CONE, OUTER (67048)	4
45	92589	GUY ROD ASSY	4	65	9042	CUP, OUTER (LM67010)	4
48	CSNC10X112	5/8 X 7 CAPSCR - GR 5	AR	66	9035	HUB ASSY, INCL CUPS	4
49	CSNC10X80	5/8 X 5 CAPSCR - GR 5	AR	67	9037	CUP, INNER (JL69310)	4
50	LW10SP	5/8 LOCK WASHER	AR	68	9039	CONE, INNER (JL69349)	4
51	NUT10NC	5/8 NUT NC - GR 5	AR	69	9038	GREASE SEAL	1
52	92583	PIVOT BRACKET	4	70	92590R	SPINDLE ASSY - RIGHT	1
53	92584	CLAMP PLATE	4	71	9229920	TONGUE JACK MOUNT	1
54	CSNC12X56	3/4 X 3-1/2 CAPSCR GR 8	2	72	CSNC10X32	5/8 X 2 CAPSCR - GR 5	AR
55	CSNC12X48	3/4 X 3 CAPSCR - GR 8	AR				

Quantities are per rake

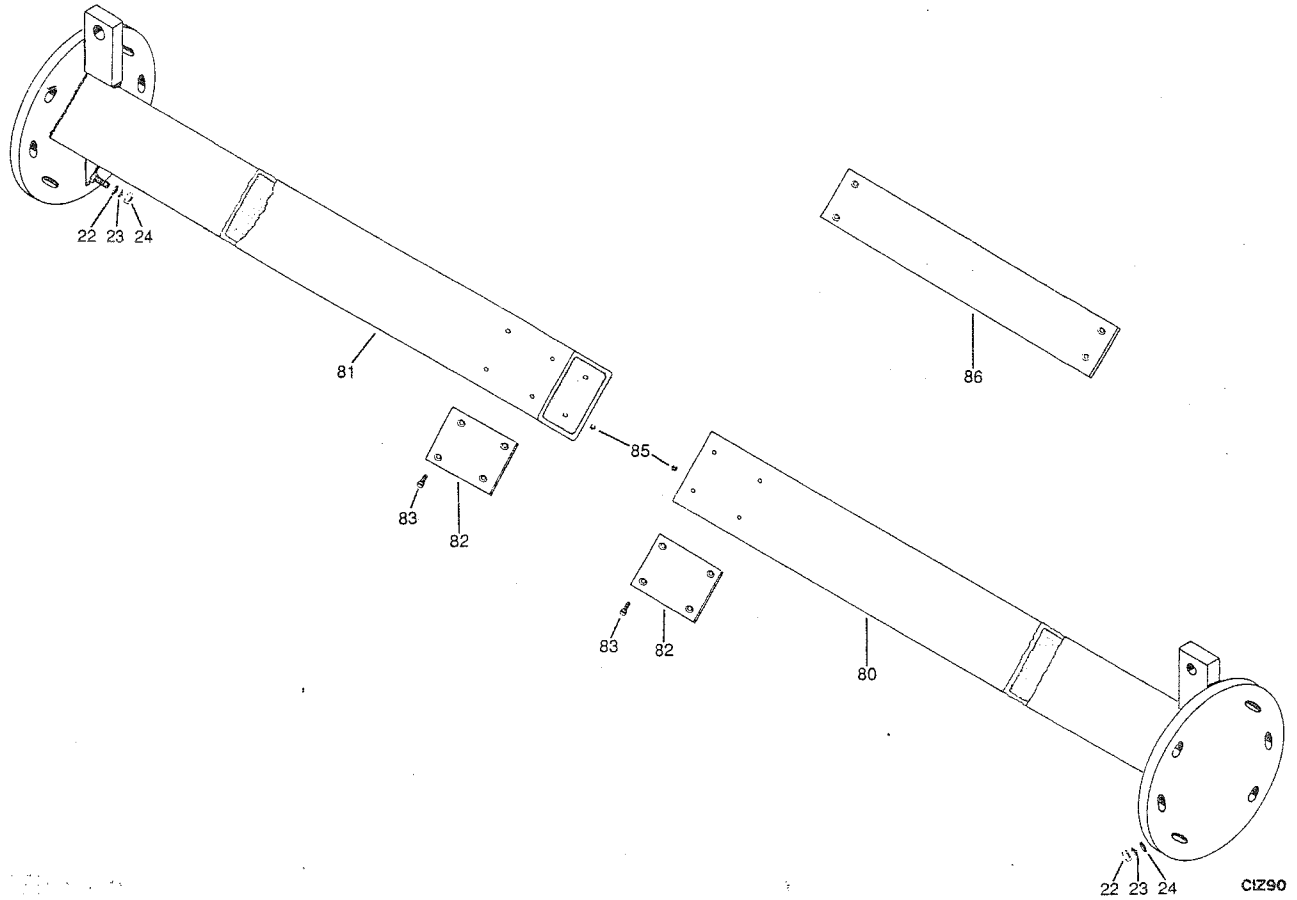

REF	PART NUMBER	DESCRIPTION	QTY
22	FLATWA06	3/8 FLAT WASHER	AR
23	LW06SP	3/8 LOCK WASHER	AR
24	NUT06NC	3/8 NC NUT - GR 5	AR
80	92285	SLIDE - RIGHT OR LEFT	1
82	93100	3/16 UMHW BEARING, 3-1/2 X 6	AR
	Used after S/N 54579		
82	93101	1/4 UMHW BEARING, 3-1/2 X 6	AR
	Used after S/N 54578		
83	PHMS04X16	1/4 FLAT HEAD MACHINE SCREW	AR
85	NUT04NCLK	1/4 NC NUT, NYLON LOCK	AR
86	92284	3/16 UMHW BEARING, 3-1/2 X 24	AR
	Used to S/N 54579		
86	92283	1/4 UMHW BEARING, 3-1/2 X 24	AR
	Used to S/N 54579		
	Quantities are per rake		

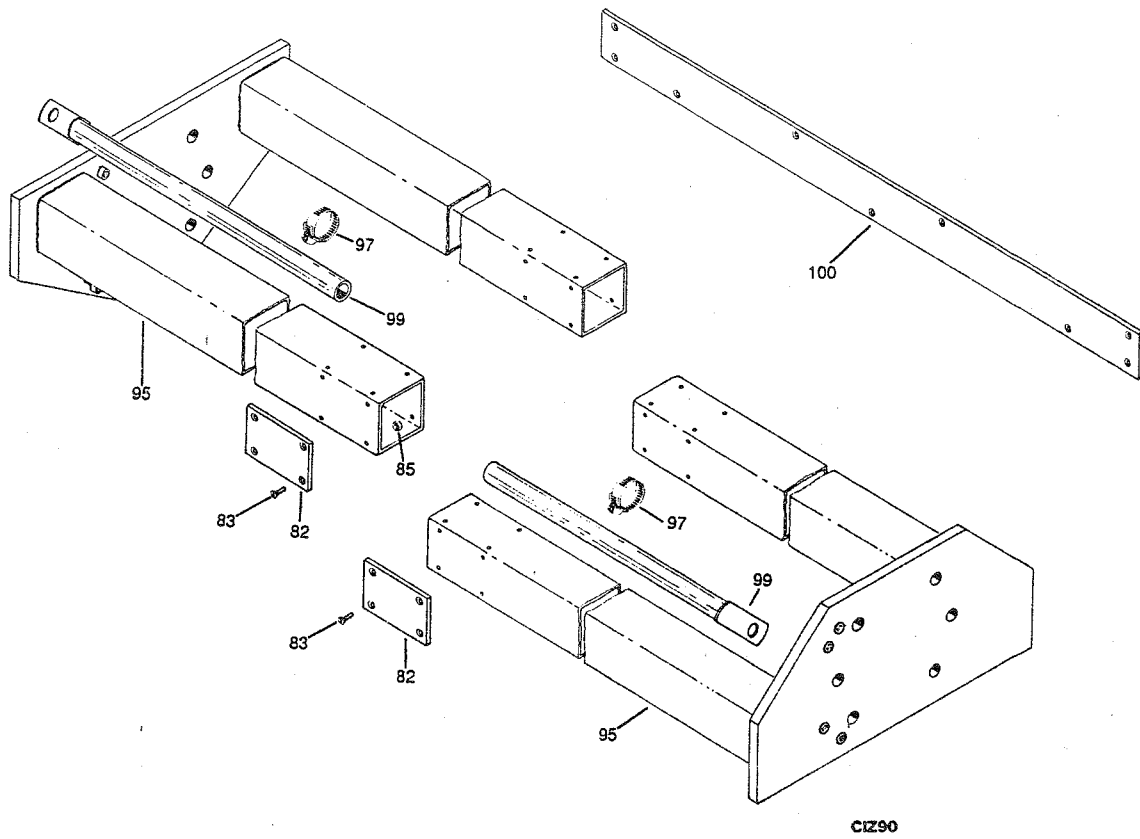

REF	PART NUMBER	DESCRIPTION	QTY
82	93100	3/16 UMHW BEARING, 3-1/2 X 6	AR
82	93101	1/4 UMHW BEARING, 3-1/2 X 6	AR
83	PHMS04X16	1/4 X 1 FLAT HEAD MACHINE SCREW	AR
85	NUT04NCLK	1/4 NC NUT - NYLON LOCK	AR
95	93285	SLIDE - RIGHT OR LEFT	2
97	B24H	WORM DRIVE CLAMP - #24	2
99	93287	HOSE SUPPORT	2
100	92102	3/16 UMHW BEARING, 3-1/2 X 48	AR
		Used on S/N 54443 to 54461 only	
100	92103	1/4 UMHW BEARING, 3-1/2 X 48	AR
		Used on S/N 54443 to 54461 only	
NOTE: Formed bearing not used with 92102 or 92103			
Quantities are per rake			

REF	PART NUMBER	DESCRIPTION	QTY
9	92RC19	1 CYLINDER PIN	2 PER CYL
10	HAIR12	HAIR PIN - #12	4 PER CYL
22	FLTWA06	3/8 FLAT WASHER	AR
23	LW06SP	3/8 LOCK WASHER	AR
24	NUT06NC	3/8 NC NUT - GR 5	AR
50	LW10SP	5/8 LOCK WASHER	AR
51	NUT10NC	5/8 NC NUT - GR 5	AR
84	LW04SP	1/4 LOCK WASHER	AR
85	NUT04NC	1/4 NC NUT - GR 5	AR
110	92286	OVERHEAD FRAME	1
111	92284A	3/16 UMHW FORMED BEARING	AR
111	92283A	1/4 UMHW FORMED BEARING	AR
112	03PCCHAIN8	SAFETY TRANSPORT CHAIN	2
113	CSNC1024	5/8 X 1-1/2 CAPSCREW - GR 5	AR
114	CSNC04X16	1/4 X 1 CAPSCREW - GR 5	AR
115	3036AR	3 X 36 MAIN CYLINDER	2
116	92297	BRACE	2
117	NUT04NC	1/4 NC NUT - GR 5	AR

Quantities are per rake unless otherwise stated

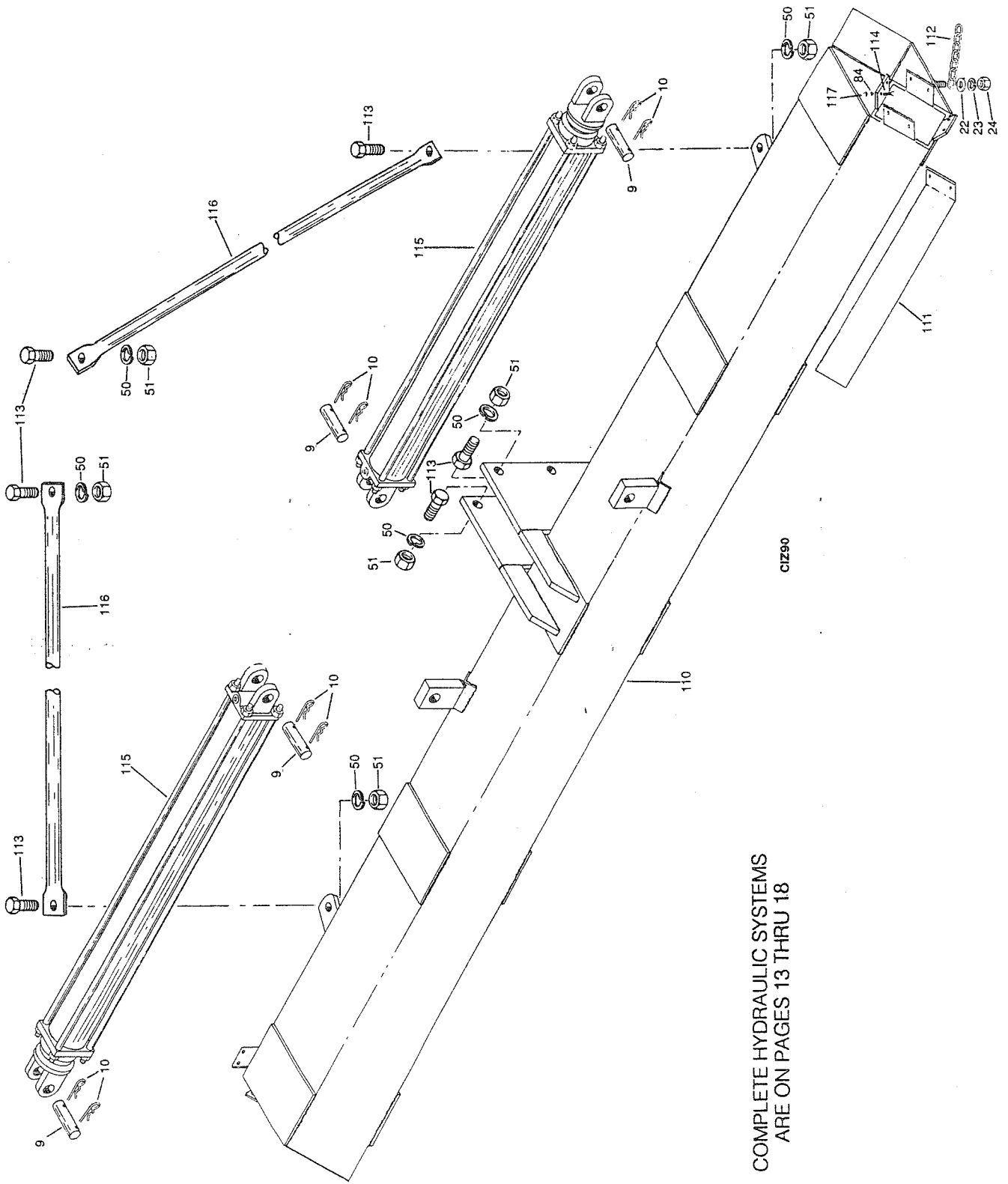

COMPLETE HYDRAULIC SYSTEMS
ARE ON PAGES 13 THRU 18

REF	PART NUMBER	DESCRIPTION	QTY
9	92RC19	1" CYLINDER PIN	2 PER CYL
10	HAIR12	HAIR PIN - #12	4 PER CYL
22	FLTWA06	3/8 LOCK WASHER	AR
23	LW06SP	3/8 LOCK WASHER	AR
24	NUT06NC	3/8 NC NUT - GR 5	AR
54	CSNC12X56	3/4 X 3-1/2 CAPSCREW - GR 5	AR
56	LW12SP	3/4 LOCK WASHER	AR
57	NUT12NC	3/4 NC NUT - GR 5	AR
84	LW04SP	1/4 LOCK WASHER	AR
111	92284A	3/16 UMHW FORMED BEARING	AR
		Used after S/N 54578	
111	92283A	1/4 UMHW FORMED BEARING	AR
		Used after S/N 54578	
112	03PCCHAIN8	SAFETY TRANSPORT CHAIN	2
114	CSNC04X16	1/4 X 1 CAPSCREW - GR 5	AR
117	NUT04NC	1/4 NC NUT - GR 5	AR
125	93286	OVERHEAD FRAME	1
126	93288	HOSE COVER	4
127	B8H	WORM DRIVE CLAMP, #8, STD ONLY	2
128	B12H	WORM DRIVE CLAMP, #12, FD ONLY	2
129	03PCCHAIN1	SINGLE CHAIN LINK	2
130	FLTWA04	1/4 FLAT WASHER	AR
131	654	HOSE RETURN SPRING	2
132	93289	HOSE CLAMP	10
133	3048AR	3 X 48 MAIN CYLINDER	2

Quantities are per rake unless otherwise stated

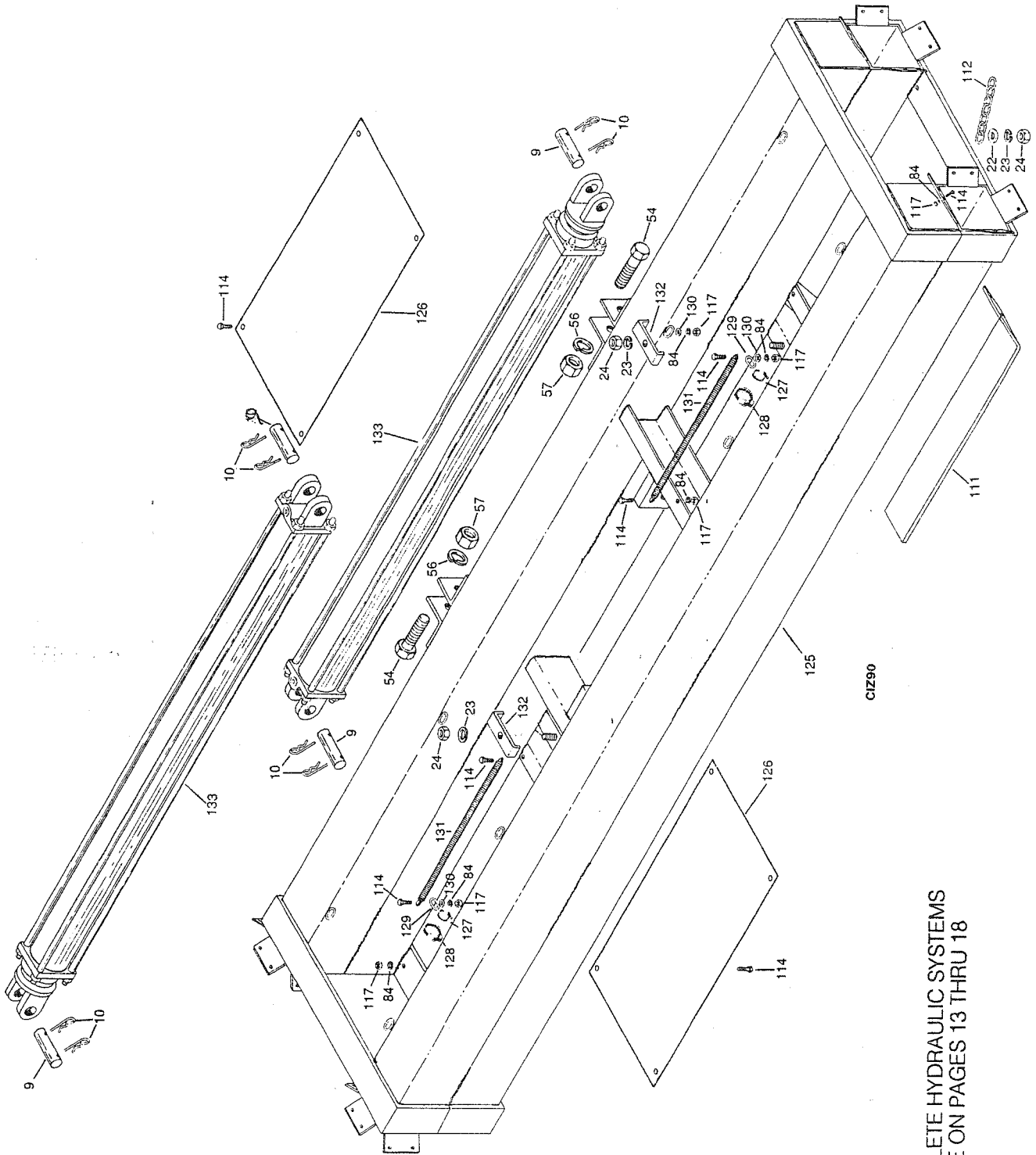

CIZ90

COMPLETE HYDRAULIC SYSTEMS
ARE ON PAGES 13 THRU 18

925 DRAWBAR

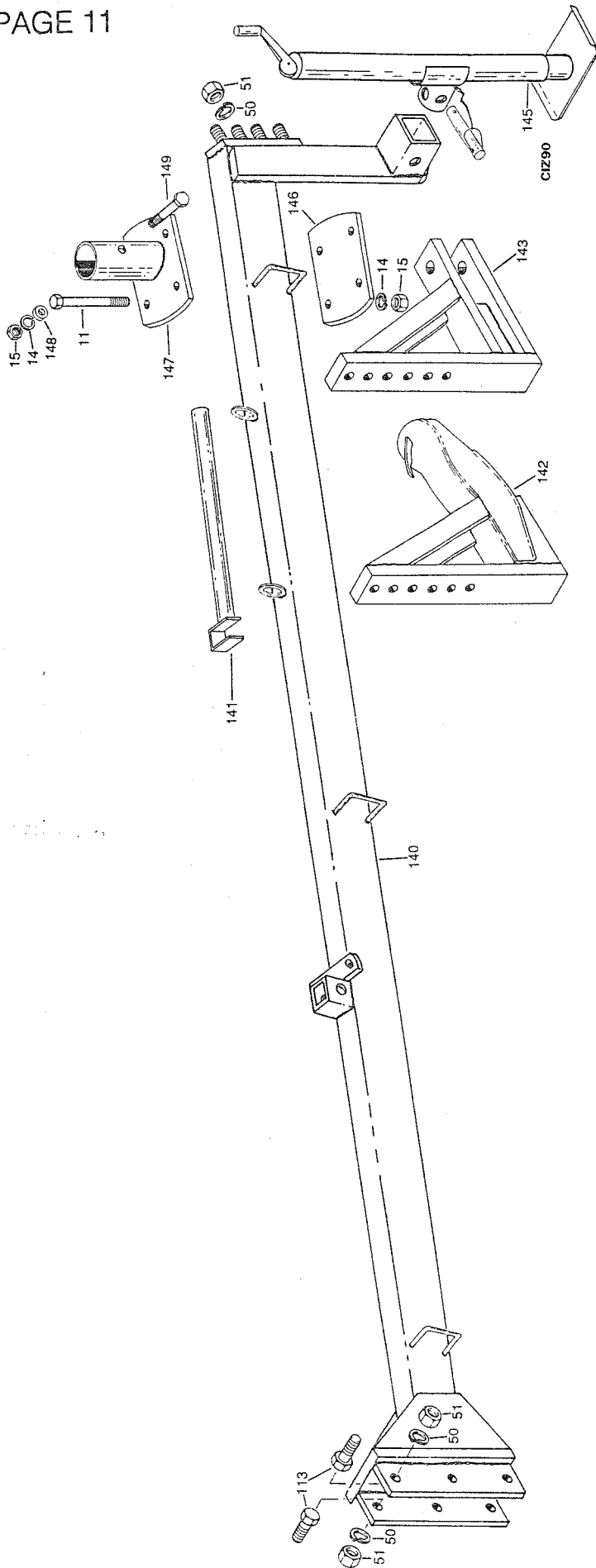

REF	PART NUMBER	DESCRIPTION	QTY
11	CSNC08X112	1/2 X 7 CAPSCREW - GR 5 - FD	AR
14	LW08SP	1/2 LOCK WASHER - FD	AR
15	NUT08NC	1/2 NUT NC - GR 5 - FD	AR
50	LW10SP	5/8 LOCK WASHER	AR
51	NUT10NC	5/8 NUT NC - GR 5	AR
113	CSNC10X24	5/8 X 1-1/2 CAPSCREW - GR 5	AR
140	92298	DRAWBAR	1
141	9229930	LEVER, WHEEL ADJUST	1
142	92299B	BALL HITCH, OPTIONAL	1
143	92299	HITCH, STANDARD	1
145	82471	TONGUE JACK W/PIN & CHAIN	1
146	92301-17	CLAMP PLATE - FD	1
147	92301-18	VALVE STAND BRACKET - FD	1
148	SCOLLAR08	1/2 SET COLLAR - FD	1
149	CSNC08X56	1/2 X 3-1/2 CAPSCREW - GR 5 - FD	1

Quantities are per rake

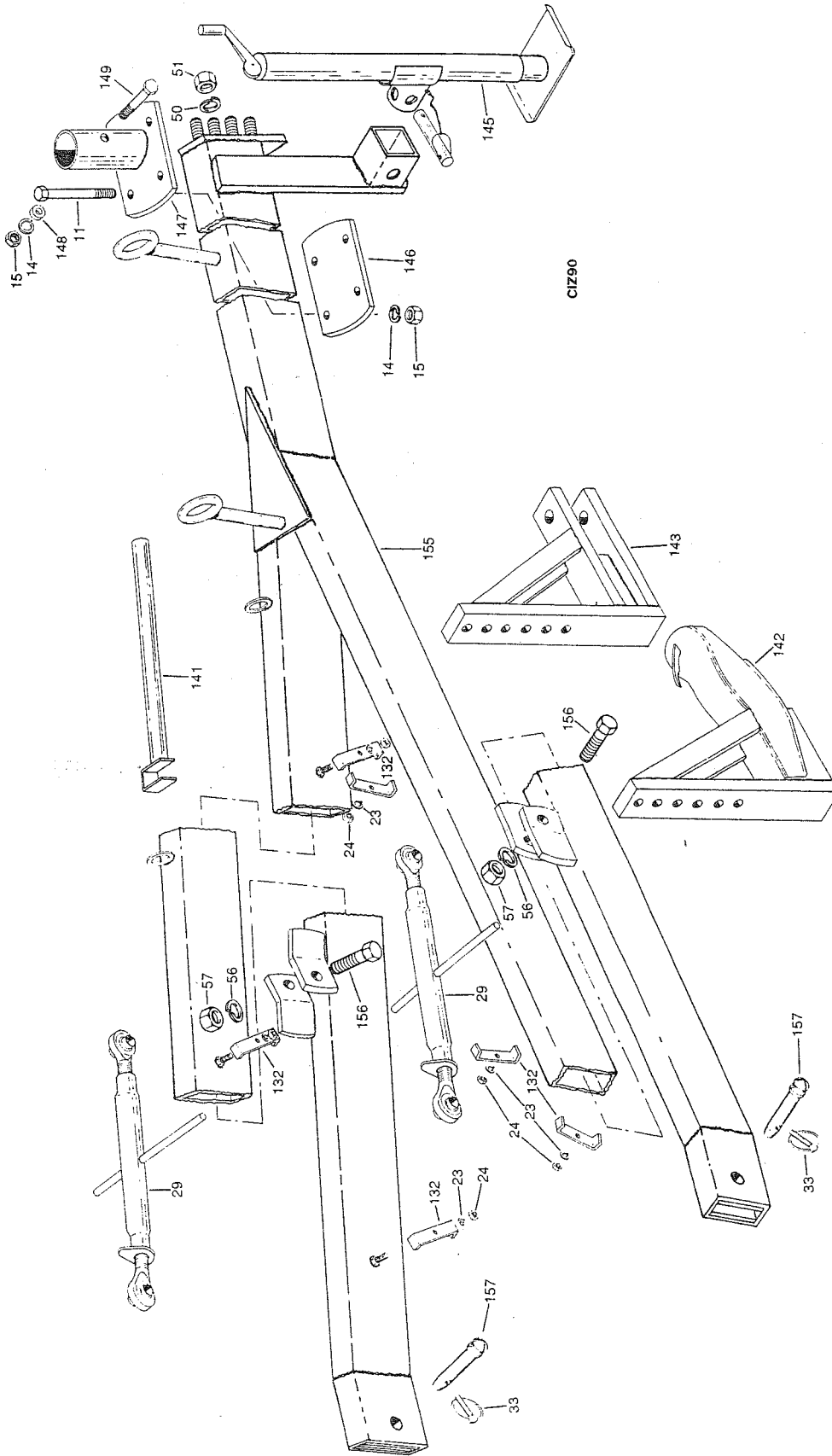

REF	PART NUMBER	DESCRIPTION	QTY	REF	PART NUMBER	DESCRIPTION	QTY
11	CSNC08X112	1/2 X 7 CAPSCR - GR 5	AR	141	9229930	LEVER, WHEEL ADJUST	1
14	LW08SP	1/2 LOCK WASHER	AR	142	922998B	BALL HITCH, OPTIONAL	1
15	NUT08NC	1/2 NUT NC - GR 5	AR	143	92299	HITCH, STANDARD	1
23	LW06SP	3/8 LOCK WASHER	AR	145	82471	TONGUE JACK W/PIN & CHAIN	1
24	NUT06NC	3/8 NUT NC - GR 5	AR	146	92301-17	CLAMP PLATE, FD ONLY	1
29	TL165P	ADJUSTING LINK	STD 4, FD 2	147	93201-18	VALVE STAND BRKT, FD ONLY	1
33	2016	LINCH PIN	AR	148	SCOLLAR08	1/2 SET COLLAR, FD ONLY	1
50	LW10SP	5/8 LOCK WASHER	AR	149	CSNC08X56	1/2 X 3-1/2 CAPSCR - GR 5	1
51	NUT10NC	5/8 NUT NC - GR 5	AR	155	93098	DRAWBAR	1
56	LW12SP	3/4 LOCK WASHER	AR	156	CSNC12X56	3/4 X 3-1/2 CAPSCR - GR 5	2
57	NUT12NC	3/4 NUT NC - GR 5	AR	157	2014	DRAWBAR PIN	2
132	93218	HOSE CLAMP	10				

Quantities are per rake

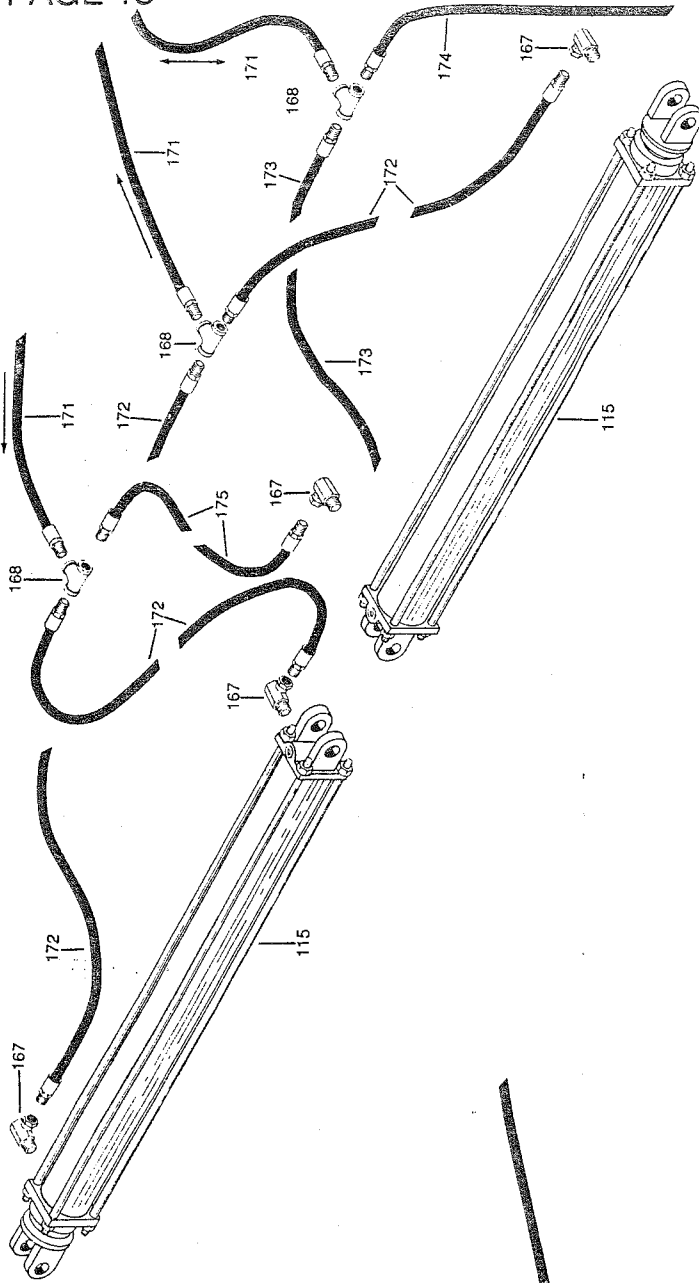

REF	PART NUMBER	DESCRIPTION	QTY
9	92RC19	1" CYLINDER PIN	2 PER CYL
10	HAIR12	HAIR PIN - #12	4 PER CYL
28	2008SAE	2 X 8 ASAE LIFT CYLINDER	2
115	3036AR	3 X 36 MAIN CYLINDER	2
165	MPPFX90-6	90° SWIVEL ADAPTER	2
166	BCP375	CYLINDER PLUG	2
167	MPPFX90-8-6	90° SWIVEL ADAPTER	4
168	PF06TEE	3/8" TEE	3
169	SKAR12104A	2" CYL REPAIR KIT	1 PER CYL
170	SKAR14106	3" CYL REPAIR KIT	1 PER CYL
171	06X3360	3/8" X 210 HOSE, 1/2 & 3/8 ENDS	3
172	06X980	3/8" X 60 HOSE, 3/8 ENDS	2
173	06X3872	3/8" X 242 HOSE, 3/8 ENDS	1
174	06X3584	3/8" X 224 HOSE, 3/8 ENDS	1
175	06X384	3/8" X 24 HOSE, 3/8 ENDS	1

Quantities are per rake unless otherwise stated.

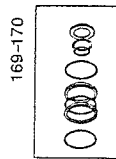
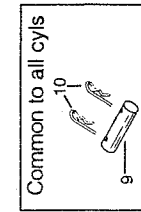
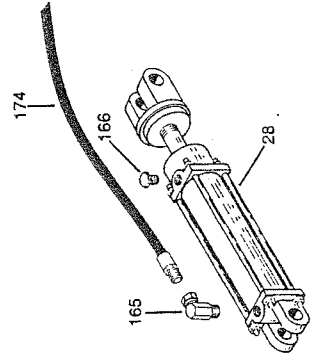
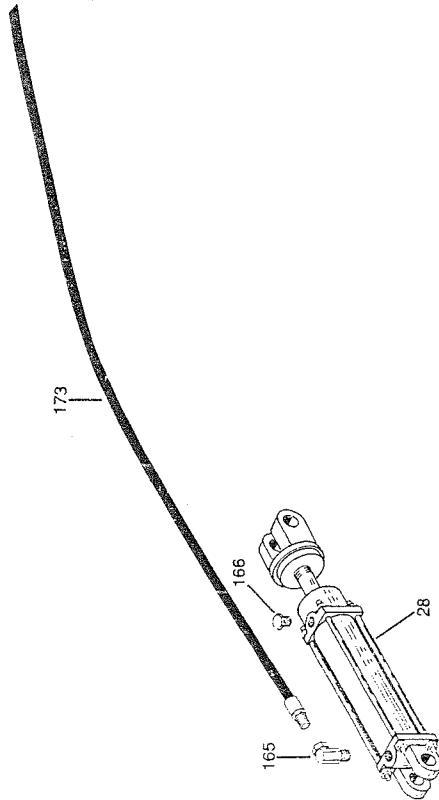

C1Z90

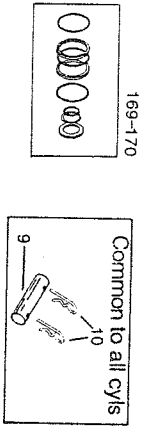
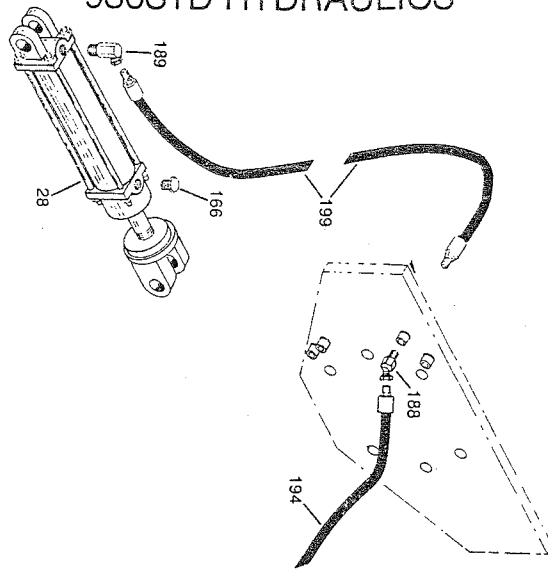

REF	PART NUMBER
9	92RC19
10	HAIR12
28	200SSAE
133	304BAR
166	BCP375
167	MPEPY90-8-6
168	PE06TEE
169	PE04TEE
170	SKAR12104A
185	SKAR14105
186	PF08TEE
187	PF04TEE
188	PF8XCINP
189	MPEPY45-4
190	MPEPY30-6-4
191	06X3480
192	06X3456
193	06X3594
194	06X1024
195	06X1920
196	06X352
197	06X1248
198	06X2368
199	06X1904

DESCRIPTION	QTY
1 CYLINDER PIN	2 PER CYL
HAIR PIN - #12	4 PER CYL
2 X 8 ASAE LIFT CYLINDER	2
3 X 48 MAIN CYLINDER	2
CYLINDER PLUG	2
90° SWIVEL ADAPTER	4
3/8 TEE	1
2 CYL REPAIR KIT	1 PER CYL
3 CYL REPAIR KIT	1 PER CYL
1/2 TEE	1
1/4 TEE	1
1/2 CLOSE NIPPLE	1
45° SWIVEL ADAPTER	2
90° SWIVEL ADAPTER	2
3/8 X 240 HOSE, 1/2 & 3/8 ENDS	1
3/8 X 216 HOSE, 1/2 & 3/8 ENDS	1
3/8 X 224 HOSE, 1/2 & 1/4 ENDS	1
3/8 X 64 HOSE, 3/8 ENDS	1
3/8 X 120 HOSE, 3/8 & 1/4 ENDS	1
3/8 X 22 HOSE, 3/8 ENDS	1
3/8 X 14 HOSE, 1/2 & 3/8 ENDS	1
3/8 X 78 HOSE, 1/4 ENDS	1
3/8 X 148 HOSE, 1/4 ENDS	1
3/8 X 119 HOSE, 1/4 ENDS	1

Quantities are per rake unless otherwise stated.

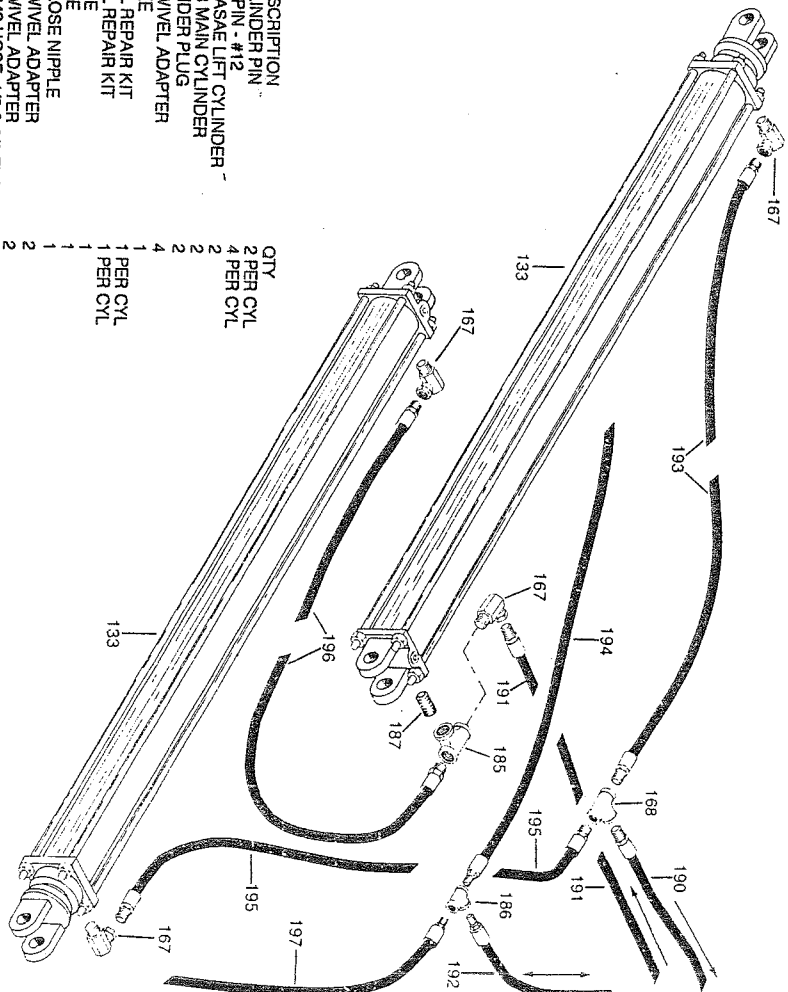
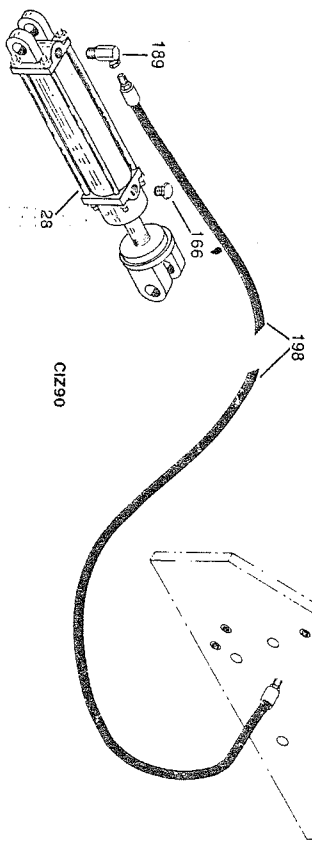

Q1Z90

Service ports are numbered from left to right when viewed from the rear.
 Odd numbers are the top row. Even numbers are in the bottom row.

REF	PART NUMBER	DESCRIPTION	QTY
8	3008SAE	3 X 8 ANGLE CYLINDER	2
9	92RC19	1" CYLINDER PIN	2 PER CYL
10	HAIR12	HAIR PIN - #12	4 PER CYL
28	2008SAE	2 X 8 ASAE LIFT CYLINDER	2
115	3036AR	3 X 36 MAIN CYLINDER	2
165	MPFPX90-6	90° SWIVEL ADAPTER	2
166	BCP375	CYLINDER PLUG	2
167	MPFPX90-8-6	90° SWIVEL ADAPTER	8
169	SKAR12104A	2" CYL REPAIR KIT	1 PER CYL
170	SKAR14106	3" CYL REPAIR KT	1 PER CYL
209	93219-19	VALVE STAND	1
211	92301-16	SLIDING VALVE BRACKET	1
212	92202	T BOLT	1
213	SD11/6KIT	6 SPOOL VALVE	1
214	MBFPX90-12-8	90° SWIVEL ADAPTER	2
215	CSNC05X48	5/16 X 3 CAPSCREW - GR 5	3
216	LW05SP	5/16 LOCK WASHER	3
217	NUT05NC	5/16 NUT NC - GR 5	3
218	SD11MD	VALVE HANDLE	6
219	SD11NUT	NUT, VALVE HANDLE	6
220	SD11BOOT	RUBBER BOOT	6
221	MBFP14-8	ADAPTER, BY PASS PORT	1
222	MPFP8-6	BUSHING, BY PASS PORT	1
223	MPFPFP6-6-6	TEE, SPECIAL BY PASS PORT	1
224	MPFPX90-6-6	STREET ELBOW, SPECIAL, BY PASS PORT	1
225	MBFP10-6	STR SWIVEL ADAPTER	12
227	08X1344	1/2 X 84 HOSE, TRACTOR TO VALVE	2
228	06X288	3/8 X 18 HOSE, 3/8 ENDS, PORTS 10 & 12 TO BY PASS PORT	2
229	06X3744	3/8 X 234 HOSE, 3/8 ENDS, PORT 1 TO L MAIN CYL PIST PORT	1
230	06X4320	3/8 X 270 HOSE, 3/8 ENDS, PORT 2 TO L MAIN CYL ROD PORT	1
231	06X3744	3/8 X 234 HOSE, 3/8 ENDS, PORT 3 TO R MAIN CYL PIST PORT	1
232	06X4320	3/8 X 270 HOSE, 3/8 ENDS, PORT 4 TO R MAIN CYL ROD PORT	1
233	06X5408	3/8 X 338 HOSE, 3/8 ENDS, PORT 5 TO L ANGLE CYL ROD PORT	1
234	06X5600	3/8 X 350 HOSE, 3/8 ENDS, PORT 6 TO L ANGLE CYL PIST PORT	1
235	06X5408	3/8 X 338 HOSE, 3/8 ENDS, PORT 7 TO R ANGLE CYL ROD PORT	1
236	06X5600	3/8 X 350 HOSE, 3/8 ENDS, PORT 8 TO R ANGLE CYL PIST PORT	1
237	06X6944	3/8 X 434 HOSE, 3/8 ENDS, PORT 9 TO L LIFT CYL PIST PORT	1
238	06X7232	3/8 X 452 HOSE, 3/8 ENDS, PORT 11 TO R LIFT CYL PIST PORT	1

Quantities are per rake unless otherwise stated

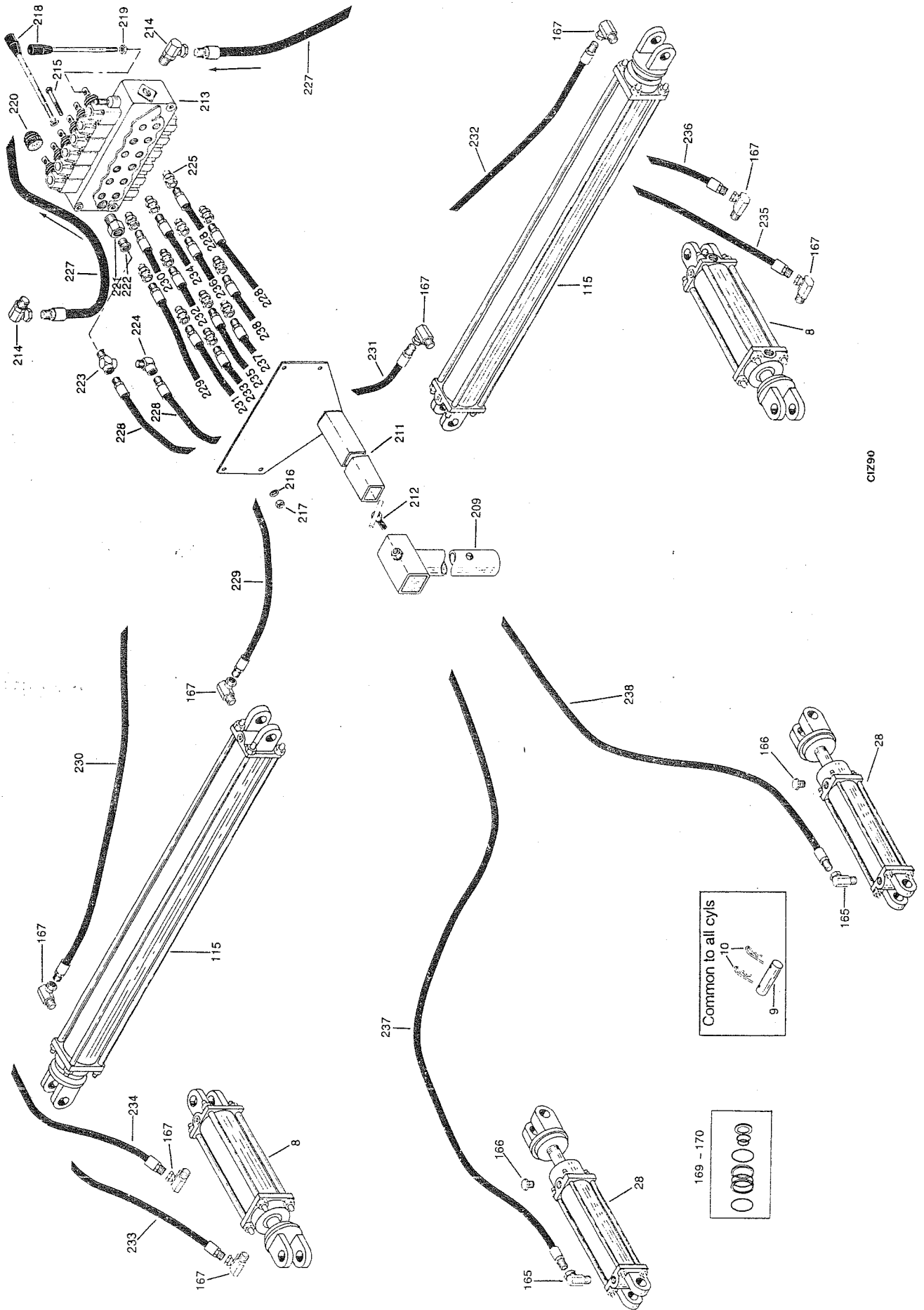

C1Z90

Service ports are numbered from left to right when viewed from the rear.
 Odd numbers are the top row. Even numbers are in the bottom row.

REF	PART NUMBER	DESCRIPTION	QTY
8	3008SAE	3 X 8 ASAE ANGLE CYLINDER	2
9	92RC19	1" CYLINDER PIN	2 PER CYL
10	HAIR12	HAIR PIN - #12	4 PER CYL
28	2008SAE	2 X 8 ASAE LIFT CYLINDER	2
133	304BAR	3 X .48 MAIN CYLINDER	2
166	BCP375	CYLINDER PLUG	2
167	MPPFX90-8-6	90° SWIVEL ADAPTER	4
169	SKAR12104A	2" CYL REPAIR KIT	1 PER CYL
170	SKAR14106	3" CYL REPAIR KIT	1 PER CYL
188	MPPFX45-4	45° SWIVEL ADAPTER	3
210	93210-16	VALVE STAND	1
211	92301-16	SLIDING VALVE BRACKET	1
212	92202	T BOLT	1
213	SD11/6 KIT	6 SPOOL VALVE	1
214	MBFPX90-12-8	90° SWIVEL ADAPTER	1
215	CSNC05X48	5/16 X 3 CAPSCREW - GR 5	2
216	LW05SP	5/16 LOCK WASHER	3
217	NUJ05NC	5/16 NUT NC - GR 5	3
218	SD11MD	VALVE HANDLE	3
219	SD11NUT	NUT, VALVE HANDLE	6
220	SD11BOOT	RUBBER BOOT	6
221	MBFP14-8	ADAPTER, BY PASS PORT	1
222	MPFP8-6	BUSHING, BY PASS PORT	1
223	MPFPFP6-6-6	TEE, SPECIAL BY PASS PORT	1
224	MPPFX90-6-6	STREET ELBOW, SPECIAL, BY PASS PORT	1
225	MBFP10-6	STR SWIVEL ADAPTER	12
227	08X1344	1/2 X 84 HOSE, TRACTOR TO VALVE	2
228	06X288	3/8 X 18 HOSE, 3/8 ENDS, PORTS 10 & 12 TO BY PASS PORT	2
245	MPPFX4	STR SWIVEL ADAPTER	3
246	MPPFX90-8-4	90° SWIVEL ADAPTER	4
247	MPPFX90-6-4	90° SWIVEL ADAPTER	2
248	06X3456	3/8 X 216 HOSE, 3/8 ENDS, PORT 1 TO L MAIN CYL PIST PORT	1
249	06X3648	3/8 X 228 HOSE, 3/8 ENDS, PORT 2 TO L MAIN CYL ROD PORT	1
250	06X3456	3/8 X 216 HOSE, 3/8 ENDS, PORT 3 TO R MAIN CYL PIST PORT	1
251	06X3648	3/8 X 228 HOSE, 3/8 ENDS, PORT 4 TO R MAIN CYL ROD PORT	1
252	04X4416	1/4 X 276 HOSE, 3/8 & 1/4 ENDS, PORT 5 TO L MTG PLATE 3RD HOLE	1
253	04X4416	1/4 X 276 HOSE, 3/8 & 1/4 ENDS, PORT 6 TO L MTG PLATE 4TH HOLE	1
254	04X4416	1/4 X 276 HOSE, 3/8 & 1/4 ENDS, PORT 7 TO R MTG PLATE 3RD HOLE	1
255	04X4416	1/4 X 276 HOSE, 3/8 & 1/4 ENDS, PORT 8 TO R MTG PLATE 4TH HOLE	1
256	06X4416	3/8 X 276 HOSE, 3/8 & 1/4 ENDS, PORT 9 TO L MTG PLATE 2ND HOLE	1
257	06X4416	3/8 X 276 HOSE, 3/8 & 1/4 ENDS, PORT 11 TO R MTG PLATE 2ND HOLE	1
258	04X800	1/4 X 50 HOSE, 1/4 ENDS, L MTG PLATE 3RD HOLE TO L ANGLE CYL ROD PORT	1
259	04X640	1/4 X 40 HOSE, 1/4 ENDS, L MTG PLATE 4TH HOLE TO L ANGLE CYL PIST PORT	1
260	04X800	1/4 X 50 HOSE, 1/4 ENDS, R MTG PLATE 3RD HOLE TO R ANGLE CYL ROD PORT	1
261	04X640	1/4 X 40 HOSE, 1/4 ENDS, R MTG PLATE 4TH HOLE TO R ANGLE CYL PIST PORT	1
262	06X1904	3/8 X 119 HOSE, 1/4 ENDS, L MTG PLATE 2ND HOLE TO L LIFT CYL PIST PORT	1
263	06X2368	3/8 X 148 HOSE, 1/4 ENDS, R MTG PLATE 2ND HOLE TO R LIFT CYL PIST PORT	1

NOTE: Mtg plate holes are numbered from top to bottom. The 1st holes are not used.
 Quantities are per rake unless otherwise stated.

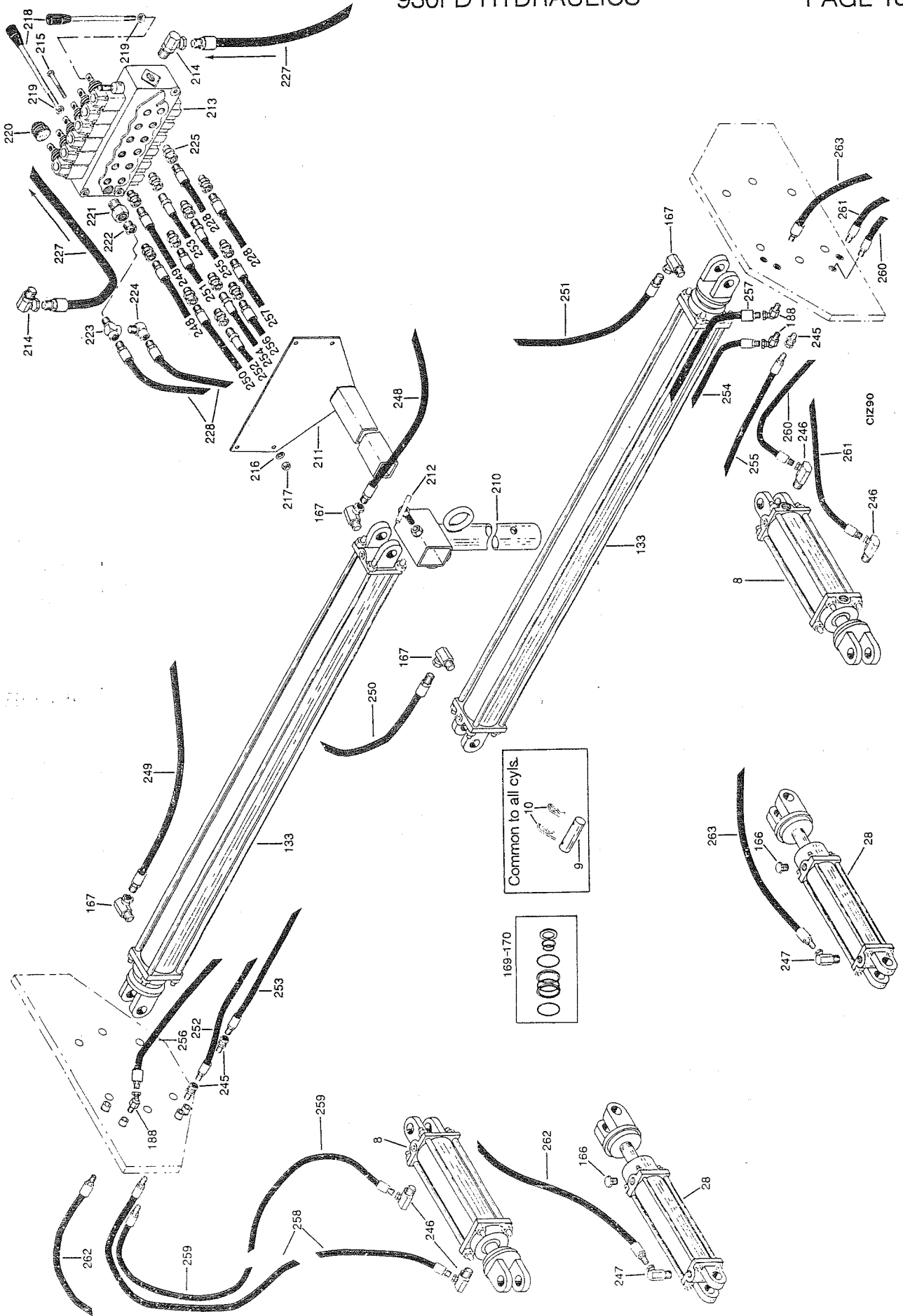

RAKING WHEEL

REF	PART NUMBER	DESCRIPTION	QTY
16	92115	BUSHING	60
17	B511ZERK	DRIVE-IN ZERK	AR
23	LW06SP	3/8 LOCK WASHER	AR
24	NUT06NC	3/8 NC NUT - GR 5	AR
25	92122A	CHAIN ASSY - COMPRESSION SPRING	15
26	92122	CHAIN - EXTENSION SPRING	15
50	LW10SP	5/8 LOCK WASHER	AR
59	9041	GREASE CAP	AR
61	COT32P	COTTER	AR
62	92125 92225	7/8 NUT, SLOTTED	AR
63	9043	FLAT WASHER	AR
72	CSNC10X32	5/8 X 2 CAPSCREW - GR 5	AR
270	92225A	RETAINER, OPT	2 PER CRANK
271	92114	RAKING WHEEL	15
272	92145B	MASONITE SHIELD	15
273	92107A	WASHER, WHEEL END, RED, 6 SLOTS	15
274	ROLLP04X40	1/2 X 2 1/2 ROLL PIN 1/4 X 3	15
275	91229	CRANK, RIGHT, PLAIN, YELLOW	15
276	91229L	CRANK, LEFT, PLAIN, RED	15
277	92219H00	92219H00 CRANK, RIGHT, BRG TYPE	8
		Includes all parts ready to assemble	
278	92219H00	92219H00 CRANK, LEFT, BRG TYPE	7
		Includes all parts ready to assemble	
279	92107	WASHER, FRAME END, YELLOW, 4 SLOTS	15
280	92121	SPRING, EXTENSION, FOR PLAIN CRANK	15
281	92221A	WIRE FORM, OPT	30
282	92221	SPRING, COMPRESSION, OPT	15
283	92219	SPINDLE, OPT	2 PER CRANK
284	9222	GREASE SEAL, OPT (471280)	2 PER CRANK
285	9220	CONE, OPT (15123)	4 PER CRANK
286	9221	CUP, OPT (15245)	4 PER CRANK
287	92219H	CRANK SUPPORT W/CUPS, OPT	15
288	CSNC06X16	3/8 X 1 CAPSCREW - GR 5	AR
289	92118	CLIP FOR STEEL TOOTH	18 PER WHEEL
290	92117	TOOTH, STEEL, RIGHT, BLK	18 PER WHEEL
291	92117L	TOOTH, STEEL, LEFT, RED	18 PER WHEEL
292	92117RL	TOOTH, RUBBER, R TO L	18 PER WHEEL
293	92175A	FASTENER ASSY, SHLD, LONG	6 PER WHEEL
294	92175	FASTENER ASSY, SHLD, SHORT	6 PER WHEEL

Quantities are per rake unless otherwise stated.

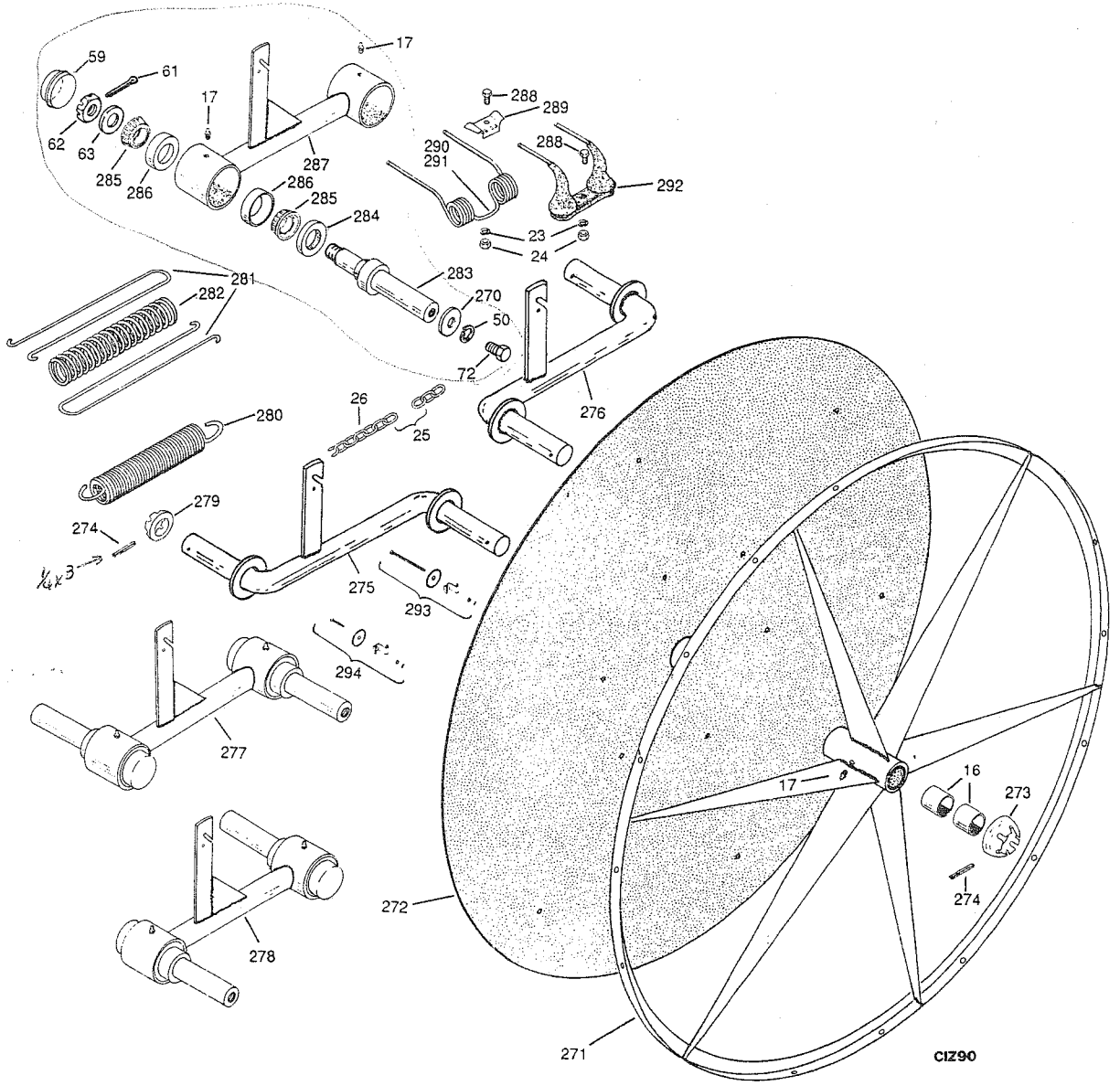

**MODEL 925 AND 930 DAF RAKE
OPERATING INSTRUCTIONS**

Maintain tire pressure: 12 PSI front, 18 PSI rear.
Adjust spring tension to allow crop to rotate raking wheels.
Do not operate raking wheels in the ground.

MODEL 925 AND 930 STANDARD HYDRAULICS

1. Install suitable hose couplers on the 3 hoses supplied. You will need 1 double acting valve to open and close the main frame and 1 single acting valve for raising and lowering the raking wheels.
2. Remove the 2 dealer installed 03PCCHAIN08 safety transport chains, Ref 112, pages 8 and 10.

TO OPEN FROM TRANSPORT POSITION TO RAKING POSITION

1. Operate the tractor single acting valve (1 hose) to raise the raking wheel to the "up" position.
2. Operate the tractor double acting valve while moving. Pull forward slowly until the main frame is fully open.
3. Use the adjusting links on the raking wheel frames to adjust raking angle as required.
4. Level raking frames to the ground by alternately adjusting the main frame to drawbar adjusting links. Applies to 930 only. For 925, see the decal on the drawbar.
5. Operate the tractor single acting valve to lower the raking wheels.
6. Check hydraulic fluid in your tractor. You will need to add approximately 2 gallons for initial start up.

NOW YOU ARE READY TO RAKE

TO CLOSE TO TRANSPORT POSITION FROM RAKING POSITION

1. Operate the tractor single acting valve to raise raking wheels to the "up" position.
2. Return raking frames to straight position.
3. Operate the tractor double acting valve while moving. Pull forward slowly until the main frame is fully closed.

NOW YOU ARE READY TO TRANSPORT

DRIVE CAUTIOUSLY. GIVE ONCOMING AND PASSING TRAFFIC AMPLE ROOM

**MODEL 925 AND 930 DARF RAKE
OPERATING INSTRUCTIONS**

Maintain tire pressure: 12 PSI front, 18 PSI rear.
Adjust spring tension to allow crop to rotate raking wheels.
Do not operate raking wheels in the ground.

MODEL 925 AND 930 FULL HYDRAULICS

1. Install suitable hose couplers on the 1/2" hoses from the valve. Insert in tractor couplers. Lock tractor remote handle in position so oil is entering at the correct valve "in" port. If your tractor is closed center, install the closed center adapter furnished with the rake valve.
2. Remove the 2 dealer installed 03PCCHAIN08 safety transport chains, Ref 112, pages 8 and 10.

TO OPEN FROM TRANSPORT POSITION TO RAKING POSITION

1. Operate the hydraulic valves indicated on the valve decal to raise the raking wheels to the "up" position.
2. Operate the frame valves indicated on the valve decal while moving. Pull forward slowly until the main frame is fully open.
3. Using the hydraulic valves indicated on the valve decal, adjust the raking wheel frames to the required angle.
4. Level raking frames to the ground by alternately adjusting the main frame to drawbar adjusting links. Applies to 930 only. For 925, see the decal on the drawbar.
5. Operate the hydraulic valves indicated on the valve decal to lower the raking wheels.
6. Check hydraulic fluid in your tractor. You will likely need to add approximately 2 gallons for initial start up.

NOW YOU ARE READY TO RAKE**TO CLOSE TO TRANSPORT POSITION FROM RAKING POSITION**

1. Operate the hydraulic valves indicated on the valve decal to raise the raking wheels to the "up" position.
2. Return raking frames to straight position.
3. Operate the frame valves indicated on the valve decal while moving. Pull forward slowly until the main frame is fully closed.

NOW YOU ARE READY TO TRANSPORT

DRIVE CAUTIOUSLY. GIVE ONCOMING AND PASSING TRAFFIC AMPLE ROOM

THESE ADDITIONAL PRODUCTS ARE AVAILABLE
FROM YOUR LOCAL DEALER

DARE

SINGLE WHEEL RAKES Pull type
DOUBLE VEE WHEEL RAKES, Pull type and 3-Point
WINDROW TURNERS

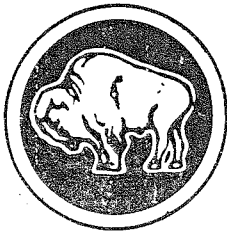

BUFFALO

DISC RIDGERS 1, 2, 3 and 4 Blade Models
"S" TINE AND SPRINGTINE FIELD CULTIVATORS
BORDER BLOCKERS AND ALFALFA BORDER MACHINERY
SLED CULTIVATORS AND SLED SPIKE HARROWS
TOOL BAR ACCESSORIES: Gauge Wheels, Square and
Rectangular Tool Bars, A-Frames: Cat I, II, III,
Tool Bar Spacers, Individual Rotary Hoes.

Valleytown
Products

PTO DRIVEN VINEYARD DUSTERS